

Tension sleeves with inner tube

Item description/product images



Description

Material:
Steel.

Version:
Plastic coated.

Note:
The traction sleeve with inner tube is a replacement part for the indexing plungers with remote actuation K1502.

On request:
Special lengths.

Accessory:
Wire cable with ball K2023.
End sleeve K2025.
Setscrew K2026.
Screw nipple K2027.
Hex nut K0700.

Drawings

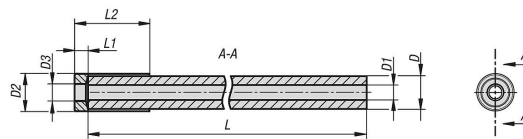

Order No.	Main material	Surface finish body	D	D1	D2	D3	L	L1	L2
K2024.0150X1000	steel	powder coated	5	2,2	5,5	2,5	1000	2	11
K2024.0150X3000	steel	powder coated	5	2,2	5,5	2,5	3000	2	11
K2024.0150X5000	steel	powder coated	5	2,2	5,5	2,5	5000	2	11